

# Profile Mixertap

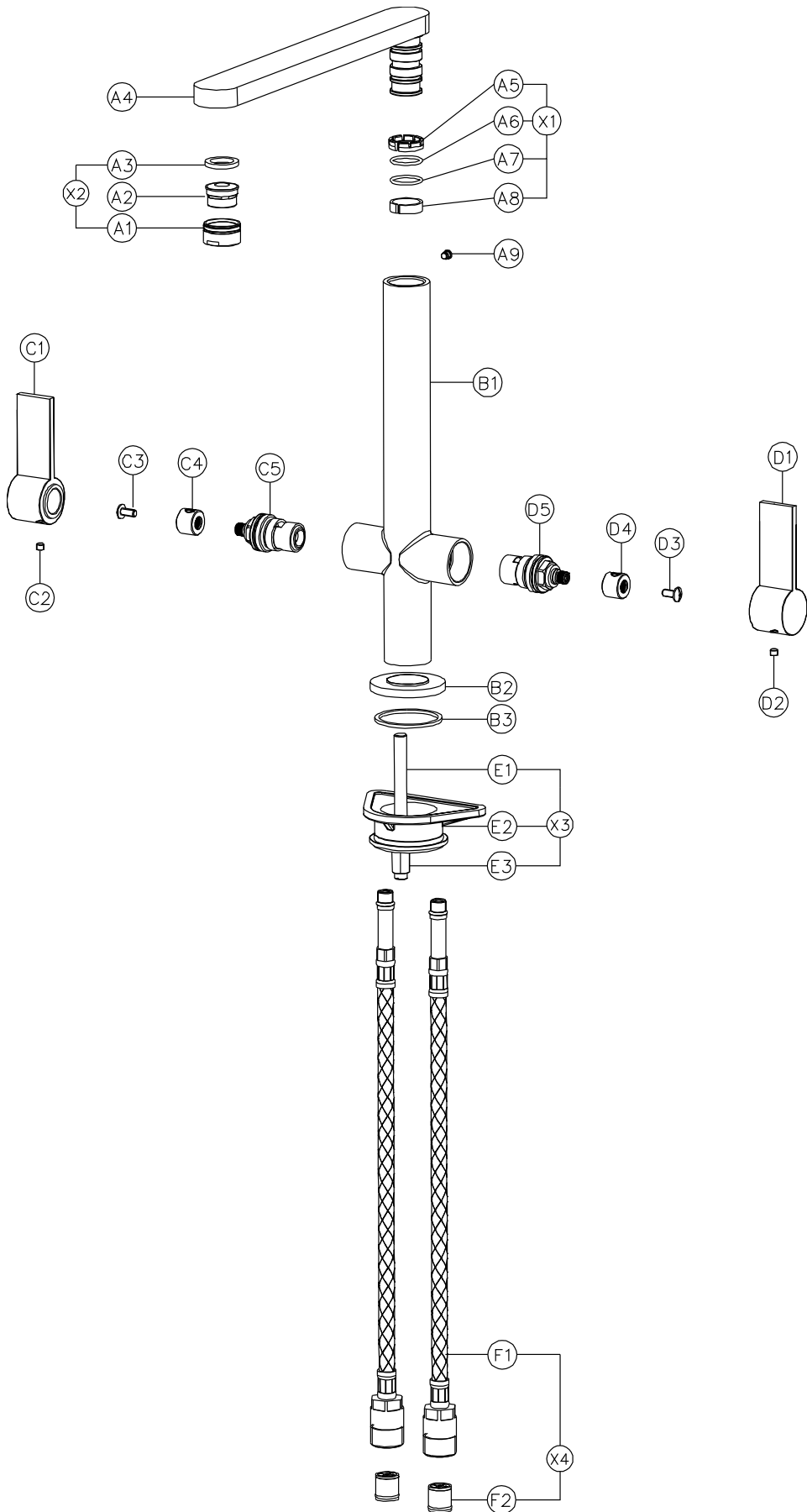

**General Advice:**

- These instructions are intended as a guide only, if you are in any doubt you should seek the advice of a qualified professional.
- Take care not to mark finished parts with screwdrivers or other tools.
- Use a pair of rubber gloves to get a better grip on decorative hand tight parts.
- Ensure all parts are reassembled tightly.
- After maintenance test that all assemblies are water tight and function correctly.
- Always isolate the hot and cold water supplies before starting any maintenance, once isolated you should drain any residual water from your system.

**To replace the hot valve:**

1. Loosen grub screw (C2) on the underside of handle (C1) using a 2mm A/F allen key.
2. Pull the handle (C1) horizontally away from the tap.
3. Unscrew (C3) and remove valve bush (C4) from the valve (C5). This valve bush (C4) should be assembled on to the new valve.
4. Hold the body of the tap (B1) firmly. Using an adjustable or 17mm ring spanner unscrew the valve (C5).
5. Clean the Inside of chamber (B1) with a soft wet cloth.
6. Reassemble the tap in the reverse order.

**To replace the spout o-rings:**

7. Loosen grub screw (A9) on the rear of body (B1) using a 2.5mm A/F allen key.
1. Pull the spout (A4) vertically away from the body (B1).
2. Remove the old o-rings (A6 & A7) using a small screwdriver or similar.
3. If worn, remove and replace white PTFE spacers (A5 & A8).
4. Ensure the inside of the body (B1) and the spout base is clean of dirt and grit with a soft wet cloth.
5. Carefully locate the new O-rings (A6 & A7) onto the spout base (A4).
6. Grease the O-rings thoroughly with silicone or alternative similar grease.
7. Reassemble the tap in the reverse order.